



扫二维码即可下载  
“Godox Light”手机APP  
Scan the QR code directly to download the  
“GodoxLight” smartphone APP



合格证  
QC PASS

### 深圳市神牛摄影器材有限公司

地址: 深圳市宝安区福海街道塘尾社区福川工业区厂房2栋  
电话: 0755-29609320(8062) 传真: 0755-25723423 邮箱: godox@godox.com

### GODOX Photo Equipment Co., Ltd.

Add: Building 2, Yaochuan Industrial Zone, Tangwei Community, Fuhai Street, Bao'an District,  
Shenzhen, China Tel: +86-755-29609320(8062) Fax: +86-755-25723423 E-mail: godox@godox.com

godox.com

Made in China



# Godox

RGB条灯  
RGB Tube Light

# TL30

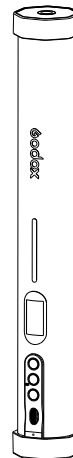

说明书  
Instruction Manual

## 前言

感谢您购买神牛产品！

RGB条灯TL30是一款带有双色温、RGB功能，高亮度，有多种情景模式的常亮灯，适用于任何场景：直播、野外露营、自拍、静物拍摄、化妆照明、视频录播、婚纱摄影、儿童拍摄及有限空间内补光、轻松动感补光等。操作便捷。

产品有以下亮点：

- 一灯多用，随心切换LED双色温模式、彩光模式和13类37种情景光效模式
- 自由调节色温、亮度、色相和色彩饱和度
- 多灯联控，手机APP遥控
- 随心组合，打造各类创意灯光造型组
- 两端有磁吸功能，可贴附在墙壁、电梯壁等铁制品平面，也可手持，灵活改变角度
- 短小便携

## 警告

- △ 请保持干燥：请勿用湿手接触产品，亦不可将产品浸入水中或暴露于雨中。
- △ 请勿私自拆卸产品，如产品出现故障须由本公司或授权的维修人员进行检查维修。
- △ 请勿让儿童接触本产品。
- △ 本产品不能防水，在雨天及潮湿环境下请注意防水。
- △ 请勿在化学品、可燃性气体或其他特殊物质附近使用摄影灯。在这些场合下，请注意相关警告标识。
- △ 内置锂电池，禁止拆卸、撞击、挤压或投入火中，若出现严重鼓胀，请勿继续使用。请勿放置在超过40°C的高温环境中。

## 部件名称

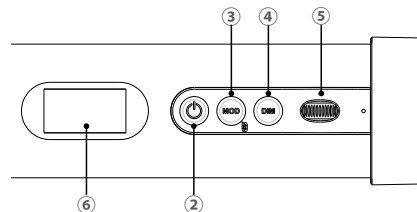
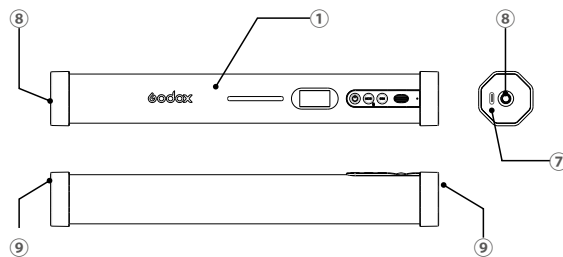

- |          |                 |
|----------|-----------------|
| 1. 机身    | 6. 显示屏          |
| 2. 电源开关键 | 7. Type-C USB接口 |
| 3. MOD按键 | 8. 固定螺孔         |
| 4. DIM按键 | 9. 磁铁吸附         |
| 5. 调节拨轮  |                 |

## 标配物品

单灯套装标配物品：

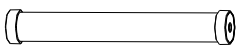

灯体 \*1



铁片 \*3



3M胶魔术贴 \*3对



收纳袋 \*1



Type-C 充电线 \*1



防滑挂绳 \*1



说明书 \*1

## 电源管理

### 1. 供电

内置锂电池，充满一次电100%亮度持续常亮约1小时。也能直接USB供电。

### 2. 充电

使用5V/2A充电器(另购)，充电时间约1小时30分钟。充电时显示屏电池符号格数跳动，充满电电池显示满格。

## 功能使用操作说明

### 1. 开关机

长按开关电源键1.5s实现开机或关机，开机时OLED显示当前信息。

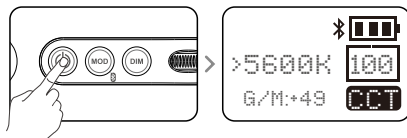

### 2. 模式选择：双色温模式/彩光模式/光效模式

按MOD按键切换模式：



显示屏上显示为CCT即为双色温模式。

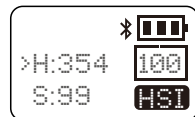

显示HSI即为彩光模式。



显示FX即为情景光效模式。

#### 2.1 双色温模式：

2.1.1 色温调节：直接滑动调节拨轮可调节色温，调节范围2700K~6500K。正常滑动调节100个单元值，快速滑动调节500个单元值。

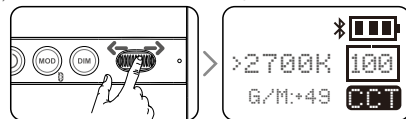

2.1.2 亮度调节：按DIM按键，亮度参数闪烁，滑动调节拨轮可调节亮度，调节范围0~100。正常滑动调节1个单元值，快速滑动调节10个单元值。再次按DIM键实现确认，参数停止闪烁。

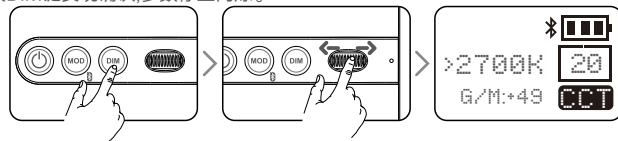

2.1.3色温调节：按MOD按键切换到CCT界面，按调节拨轮选中G/M，再拨动调节拨轮可调节色温，调节范围-50 ~ 0 ~ +50。正常滑动调节1个单元值，快速滑动调节10个单元值。

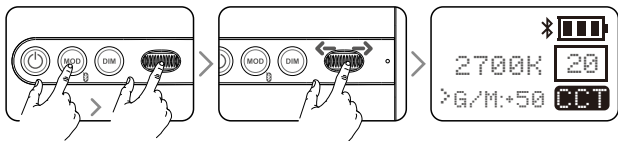

## 2.2 彩光模式：

2.2.1调节色相H：按MOD按键切换到HSI界面，按调节拨轮选中H，再滑动调节拨轮可调节色相，色相调节范围0 ~ 360°。正常滑动调节1个单元值，快速滑动调节10个单元值。

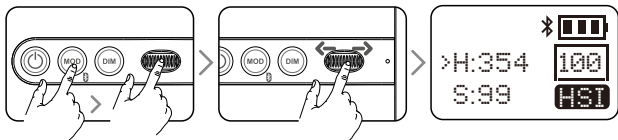

2.2.2调节饱和度S：在HSI界面，按调节拨轮选中S，再滑动调节拨轮可调节饱和度，饱和度调节范围0-100。正常滑动调节1个单元值，快速滑动调节10个单元值。

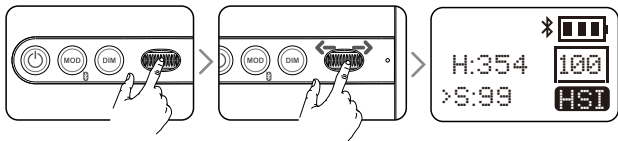

## 3. 情景光效模式(13类37种)：

3.1 按MOD按键切换到FX界面，滑动调节拨轮可选择光效模式类别，1~13类可选。

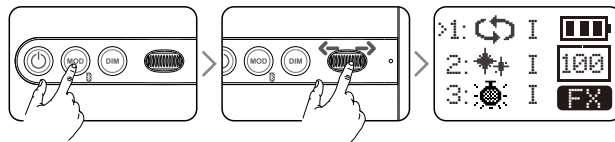

3.2 选中后按调节拨轮可选当前类别中的模式：I、II、III 3种模式

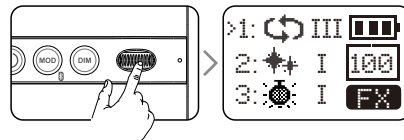

3.3 情景光效模式有13类共37种：可根据需求选择

序号	显示	场景	显示 I	显示 II	显示 III
1	🔄	彩光循环	慢速	中速	快速
2	🌟	闪光灯	闪光	发布会	狗仔队
3	🎉	激光彩灯	生日会	KTV	迪斯科
4	⚡	雷闪电	间歇	频繁	持续
5	💡	坏灯泡	间歇	频繁	持续
6	📺	电视机	慢速	中速	快速
7	🕯️	蜡烛	间歇	频繁	持续
8	🔥	火	柴火	篝火	火灾
9	🎆	烟花	短暂	连续	演出
10	🚓	警车	暴闪	频闪	快闪
11	🚒	消防车	暴闪	频闪	快闪
12	🚑	救护车	暴闪	频闪	快闪
13	SOS	SOS			

## 4. 蓝牙控制：

### 蓝牙设置：

**4.1 开关蓝牙：**长按MOD按键，进入蓝牙界面，拨动调节拨轮选中, 再按调节拨轮，显示ON为打开，显示OFF为关闭。

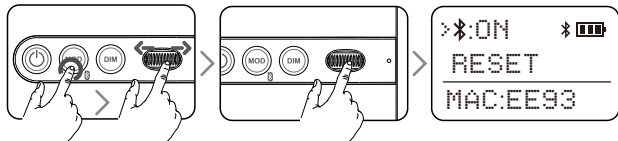

**4.2. 直接扫二维码即可下载“Godox Light”手机APP(安卓和苹果系统都可以使用)。**

具体操作请参考手机APP“帮助”手册，里面有详情教程。



**4.3 蓝牙重置功能：**在蓝牙界面拨动调节拨轮选中RESET，再按一次调节拨轮，显示屏出现RESET...表示蓝牙在重置，重置成功自动返回蓝牙界面。

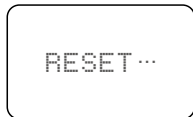

注：首个移动设备（手机或平板电脑）可直接使用APP操控灯体。更换其他移动设备（手机或平板电脑）时，灯体进行蓝牙重置后，方可正常使用APP。

## 产品参数

型号	TL30
内置锂电池供电	3.7V/2900mAh/10.7Wh
适配器	5V/2A (另购)
输出功率	最大8W
色温范围	2700K ~ 6500K
调光范围	0%~100%
RGB色域	0 ~ 360 °
100%光照度 (LUX) (≈)	740
CRI (≈)	97
TLCI (≈)	99
持续使用时间 (2700K或6500K 100%亮度) ≈	60分钟
控制方式	手机APP/灯体按键控制
蓝牙无线控制距离	≈ 30米
工作环境温度	-10~40℃
产品尺寸	Φ42*300MM
重量	0.3Kg

\* 设计和规格如有变更，恕不另行通知。

## 维护保养

- 为了防止灰尘的堆积影响到产品的性能，请定时用干净的湿布轻轻擦拭产品外部。
- 1年保修，消耗品电池，适配器，电源线等配件不在此保修范围内。
- 对于不规范操作引起的机器故障不在保修范围内。
- 所有维修概由本厂指定可供原厂配件之维修部负责。
- 经发现，擅自检修本品，将取消一年保修期，维修需要收取相关费用。
- 如果本品出现故障或者被水淋湿，在专业人员维修后方可继续使用。
- 如有技术更改，恕不另行通知。

本设备包含型号核准代码为：CMIIT ID:2020DP13510，为该产品的无线电发射模块。

## Foreword

Thank you for purchasing this Godox Product!

This RGB Tube Light TL30 is a multifunctional RGB light with dual color temperature, high light brightness and wireless adjustment. Suitable for almost all shooting occasions e.g. live, camping, make up, portrait shooting, make up, video, wedding, children photography, etc. It's portable and easy to be operated.

### Features:

- Freely switch LED CCT mode, RGB mode and 37 special effects modes.
- Easy to adjust color temperature, light brightness, hue and color saturation.
- Remote control by smartphone APP.
- Use in combination to make more creative light groups.
- Both ends have magnetic absorption function, can be attached to the plane of iron products.
- Lightweight and portable, it can be held by hand, and the angle can be flexibly changed.

## ⚠ Warning

- ⚠ Always keep this product dry. Do not use in rain or in damp conditions.
- ⚠ Do not disassemble. Should repairs become necessary, this product must be sent to an authorized maintenance center.
- ⚠ Keep out of reach of children.
- ⚠ As this product do not have waterproof function, please take measures of waterproof in rainy or damp environment.
- ⚠ Do not use the flash unit in the presence of flammable gases, chemicals and other similar materials. In certain circumstance, these materials may be sensitive to the strong light emitting from this flash unit and fire or electromagnetic interference may result.
- ⚠ As this product has built-in lithium battery, do not disassemble, impact, squeeze or put it into fire. If serious bulge occurs, please do not use. Do not use or store the product if the ambient temperature reads over 40°C.

## Names of Parts

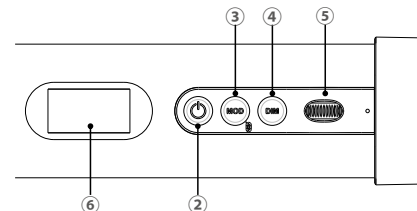
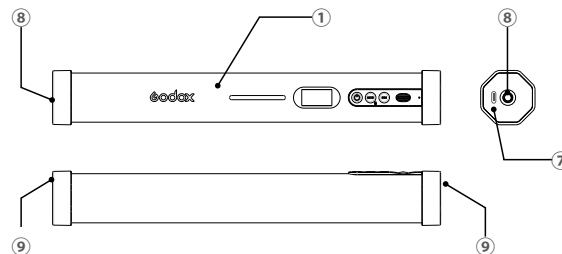

1. Main Body
2. Power Switch
3. MOD Button
4. DIM Button
5. Select Dial
6. Display
7. Type-C USB Port
8. Screw Hole
9. Magnetic Absorption

## What's in the Box

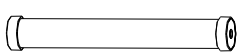

Body \*1



Metal Piece \*3



3M Paster \* 3 pairs



Portable Bag \*1



Type-C Charging Cable \*1



Lanyard \*1



Instruction Manual \*1

## Battery Management

### 1. Power Supply

With built-in lithium battery which can offer about 1 hour's lighting in 100% brightness once got fully charged.

The light can also be charged through USB cable.

### 2. Charge

The whole charging takes about 1 hour and 30 minutes when using 5V/2A charger (optional). The charge grids indicator will be blinking in charging while displaying full grids once got fully charged.

## Operation

### 1. Power Switch

Long press the switch power button for 1.5s to turn on or off. Then, the current information will be displayed on the OLED panel.

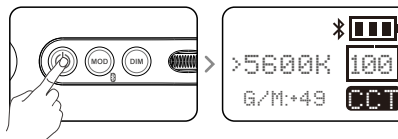

### 2. Mode Selection: CCT Mode/RGB Mode/ Special Effects Mode

Press MOD button to switch different modes:



CCT displayed on the screen means CCT mode

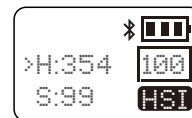

HSI displayed on the screen means RGB mode

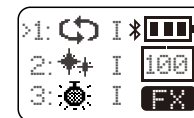

FX means special effects mode

#### 2.1 Bicolor Mode

2.1.1 Color temperature adjustment: turn the select dial to adjust the color temperature from 2700K to 6500K.

Adjustment in 500 values quickly or 100 value normally by turning the select dial.

Press DIM button again to confirm, and the parameter stops flashing.

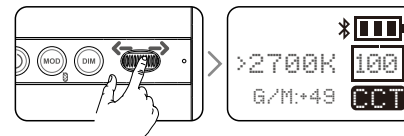

2.1.2 Press the DIM button, then, press DIM button and the brightness value will be blinking. Turn the select dial to adjust the value. Adjustment in 10 values quickly or 1 value normally by turning the select dial.

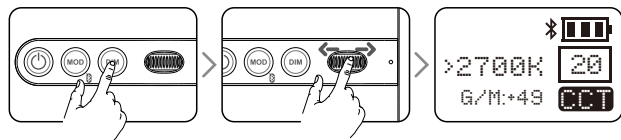

2.1.3 Hue adjustment: press the MOD button to switch to CCT interface. Press down the select dial to choose G/M and turn the select dial to adjust hue from -50 to 0 and 0 to +50. Adjustment in 5 values quickly or 1 value normally by turning the select dial.

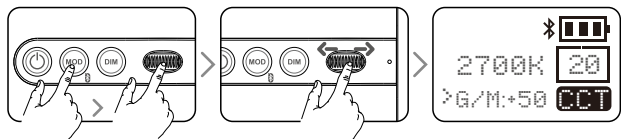

## 2.2 Colorful Mode

2.2.1 Adjust hue H: press the MOD button to switch to HSI interface. Press down the select dial to choose H and turn the select dial to adjust hue. Adjustment in 10 values quickly or 1 value normally by turning the select dial.

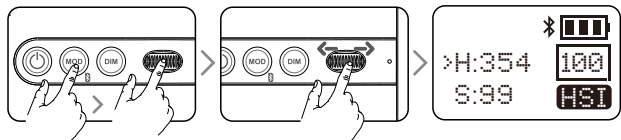

2.2.2 Adjust saturation S: in HSI interface, press down the select dial to choose S and turn the select dial to adjust saturation. Adjustment in 10 values quickly or 1 value normally by turning the select dial.

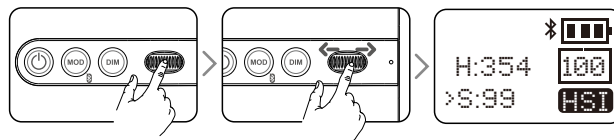

## 3. Special Effects Modes (13 categories divided into 37 kinds)

3.1 Press the MOD button to switch to FX interface. Turn the select dial to choose light effects categories from 1 to 13.

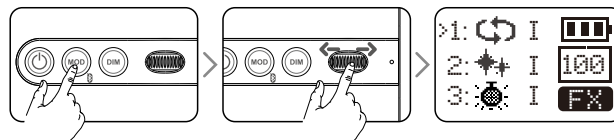

3.2 After choosing the current mode, press down the FN multifunctional select dial from I, II and III.

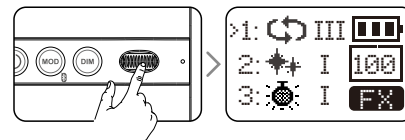



3.3 There're 37 kinds of situational special effects mode which are divided into 13 categories for your choice.

No.	Display	Situation	Display I	Display II	Display III
1		RGB cycle	Slow speed	Medium speed	Quick speed
2		Flash	Flash	Press conference	Paparazzi
3		Laser	Birthday party	KTV	Disco
4		Lightning	Discontinuous	Frequent	Sustainable
5		Broken bulb	Discontinuous	Frequent	Sustainable
6		TV	Slow speed	Medium speed	Quick speed
7		Candle	Discontinuous	Frequent	Sustainable
8		Fire	Firewood	Campfire	Fire hazard
9		Firework	Brief	Continuous	Show
10		Police car	Strong flash	Frequent flash	Quick flash
11		Fire truck	Strong flash	Frequent flash	Quick flash
12		Ambulance	Strong flash	Frequent flash	Quick flash
13		SOS			

## 4. Bluetooth Control

4.1 Bluetooth ON/OFF: Long press the MOD button to enter Bluetooth interface. Turn the select dial to choose the Bluetooth and press down to set it to ON or OFF.

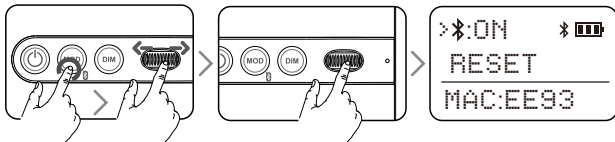

4.2 Scan the QR code to download the "Godox Light" smartphone APP (can be used by Android and Apple system). For more smartphone APP operations, please open the "help" in APP to gain detailed guidance.



4.3 Bluetooth reset function: in Bluetooth interface, turn the select dial to choose RESET. Then, press down the select dial until the RESET is displayed. The screen will auto back to Bluetooth interface after being successfully reset.

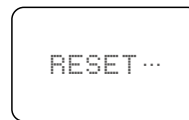

Note: the APP can be used directly on the firstly installed device (smartphone or iPad). When changing to other mobile device, the light shall be reset before the normal usage of APP.

## Technical Data

LED Light	TL30
Built-in Lithium Battery	3.7V/2900mAh/10.7Wh
Adapter	5V/2A (optional)
Output Power	Max. 8W
Color Temperature Range	2700K~6500K
Light Brightness Range	0%~100%
RGB Color Gamut	0 ~ 360°
100% Light Brightness (LUX)(≈)	740
CRI (≈)	97
TLCI (≈)	99
Duration(continuous output in 100% full power in 2700K or 6500K)	Approx. 60 minutes
Control Method	Smartphone APP
Bluetooth Wireless Control Distance	≈30m
Operation Temperature	-10~40 °C
Dimension	φ42*300MM
Net Weight	0.3Kg
BT Frequency Range	2402.0-2480.0MHz
Max. Transmitting Power	5dbm

\* Product design and specifications are subject to change without notice.

## Maintenance

This product, except consumables e.g. adapter and adapter cable, is supported with a one-year warranty.

Avoid sudden impacts and the product should be dedusted regularly.

Maintenance of the flash must be performed by our authorized maintenance department which can provide original accessories.

Unauthorized service will void the warranty.

If the product had failures or was wetted, do not use it until it is repaired by professionals.

Changes made to the specifications or designs may not be reflected in this manual.

## FCC Statement

This device complies with part 15 of the FCC Rules. Operation is subject to the following two conditions: (1) This device may not cause harmful interference, and (2) this device must accept any interference received, including interference that may cause undesired operation.

Any Changes or modifications not expressly approved by the party responsible for compliance could void the user's authority to operate the equipment.

**Note:** This equipment has been tested and found to comply with the limits for a Class B digital device, pursuant to part 15 of the FCC Rules. These limits are designed to provide reasonable protection against harmful interference in a residential installation. This equipment generates uses and can radiate radio frequency energy and, if not installed and used in accordance with the instructions, may cause harmful interference to radio communications. However, there is no guarantee that interference will not occur in a particular installation. If this equipment does cause harmful interference to radio or television reception, which can be determined by turning the equipment off and on, the user is encouraged to try to correct the interference by one or more of the following measures:

- Reorient or relocate the receiving antenna.
- Increase the separation between the equipment and receiver.
- Connect the equipment into an outlet on a circuit different from that to which the receiver is connected.
- Consult the dealer or an experienced radio/TV technician for help.

The device has been evaluated to meet general RF exposure requirement.

The device can be used in portable exposure condition without restriction.

# 产品保修

尊敬的用户，本保修卡是申请保修服务的重要凭证，请您配合销售商填写并妥善保管，谢谢！

产品信息	型号	产品条码
用户信息	姓名	联系电话
	通信地址	
销售商信息	名称	
	联系电话	
	通信地址	
	销售日期	
备注		

注：此表应由销售商盖章确认。

## 适用产品

本文件适用于相关《产品保修信息》(见后面说明)所列产品，其他非属此范围的产品或部件(如促销品、赠品及其他出厂后附加的部件等)不在此保修承诺内。

## 保修期

产品及部件的相应保修期按相关的《产品保修信息》执行。保修期自产品首次购买日起算，购买日以购买产品时保修卡登记日期为准。

## 如何获得保修服务

您可直接与产品销售商或授权服务机构联系，也可拨打神牛产品售后服务电话，与我们联系，由我们的服务人员为您安排服务。申请保修时，您应提供有效的保修卡作为保修凭证，方可获得保修。如您不能提供有效的保修卡，则在我们确认产品或部件属于保修范围的情况下，也可以为您提供保修，但这不作为我们的义务。

## 不适用保修的情况

如产品存在下列情况，本文件项下的保证和服务将不适用 ①产品或部件超过相应保修期；②错误或不当使用、维护或保管导致的故障或损坏，如：不当搬运；非按产品合理预期用途使用；不当插拔外接设备；跌落或外力挤压；接触或暴露于不适当温度、溶剂、酸碱、水浸或潮湿环境；③由非神牛授权机构或人员安装、修理、更改、添加或拆卸造成的故障或损坏；④产品或部件原有识别信息被修改变更或删除；⑤无有效保修卡；⑥使用非合法授权、非标准或非公开发行的软件造成的故障或损坏；⑦因不可抗力或意外事件造成的故障或损坏；⑧其他非因产品本身质量问题导致的故障或损坏。遇上述情况，您应向相关责任方寻求解决，神牛对此不承担任何责任。因非在保修期或保修范围内的部件、附件或软件导致产品不能正常使用的，不是保修范围内的故障。产品使用过程中正常的脱色，磨损和消耗，不是保修范围内的故障。

## 产品保修和服务支持信息

产品的保修期和服务类型按以下《产品保修信息》执行：

产品类别	选项名称	保修期(月)	保修服务类型
部件	电路板	12	客户送修
	电池	3	客户送修
	充电器、电源线，同步线等带电性能的部件。	12	客户送修
其他	如闪光管、造型灯泡、外壳、保护罩、锁紧装置、包装等。	无	无保修

神牛产品售后服务电话 0755-29609320-8062

# Warranty

Dear customers, as this warranty card is an important certificate to apply for our maintenance service, please fill in the following form in coordination with the seller and safe-keep it. Thank you!

Product Information	Model	Product Code Number
Customer Information	Name	Contact Number
	Address	
Seller Information	Name	
	Contact Number	
	Address	
	Date of Sale	
<b>Note:</b>		

Note: This form shall be sealed by the seller.

## Applicable Products

The document applies to the products listed on the **Product Maintenance Information** (see below for further information). Other products or accessories (e.g. promotional items, giveaways and additional accessories attached, etc.) are not included in this warranty scope.

## Warranty Period

The warranty period of products and accessories is implemented according to the relevant Product Maintenance Information. The warranty period is calculated from the day(purchase date) when the product is bought for the first time, And the purchase date is considered as the date registered on the warranty card when buying the product.

## How to Get the Maintenance Service

If maintenance service is needed, you can directly contact the product distributor or authorized service institutions. You can also contact the Godox after-sale service call and we will offer you service. When applying for maintenance service, you should provide valid warranty card. If you cannot provide valid warranty card, we may offer you maintenance service once confirmed that the product or accessory is involved in the maintenance scope, but that shall not be considered as our obligation.

## Inapplicable Cases

The guarantee and service offered by this document are not applicable in the following cases: ①. **The product or accessory has expired its warranty period;** ②. **Breakage or damage caused by inappropriate usage, maintenance or preservation, such as improper packing, improper usage, improper plugging in/out external equipment, falling off or squeezing by external force, contacting or exposing to the improper temperature, solvent, acid, base, flooding and damp environments, etc;** ③. **Breakage or damage caused by non-authorized institution or staff in the process of installation, maintenance, alternation, addition and detachment;** ④. **The original identifying information of product or accessory is modified, alternated, or removed;** ⑤. **No valid warranty card;** ⑥. **Breakage or damage caused by using illegally authorized, nonstandard or non-public released software;** ⑦. **Breakage or damage caused by force majeure or accident;** ⑧. **Breakage or damage that could not be attributed to the product itself.** Once met these situations above, you should seek solutions from the related responsible parties and Godox assumes no responsibility. The damage caused by parts, accessories and software that beyond the warranty period or scope is not included in our maintenance scope. The normal discoloration, abrasion and consumption are not the breakage within the maintenance scope.

## Maintenance and Service Support Information

The warranty period and service types of products are implemented according to the following **Product Maintenance Information**:

Product Type	Name	Maintenance Period(month)	Warranty Service Type
Parts	Circuit Board	12	Customer sends the product to designated site
	Battery	3	Customer sends the product to designated site
	Electrical parts e.g.battery charger, power cord, sync cable, etc.	12	Customer sends the product to designated site
Other Items	Flash tube, modeling lamp, lamp body, lamp cover, lockingdevice, package, etc.	No	Without warranty

Godox After-sale Service Call **0755-29609320-8062**